



> Available with DUX Aluminum or 3M™ PPS™ Disposable Cup System.

DUX Gravity Feed Gun

INSPIRED BY FORMULA THREE RACE CAR ENGINES.

After more than 5 years of research and development, DUX has reinvented the spray gun from the inside out. By incorporating our patented airflow technology, originally used in Formula Three racecar engines, we've developed the most innovative breakthrough in spray gun technology in nearly 80 years.

For the first time, finishers can spray nearly any type of fluid, onto nearly any surface with a single gun – while reducing coatings usage and improving finish quality.

IT PRACTICALLY PAYS FOR ITSELF AFTER JUST ONE JOB.

The DUX gun is lighter, more ergonomic, and easier to use than any other spray gun in its class, with transfer efficiency improvements over HVLP and conventional guns routinely reaching 15-40% over those existing spray technologies. In fact, the coatings savings are so significant, the gun often pays for itself in the first month of use. The spray gun uses DUX's patented technology to reduce paint and filter usage, hazardous waste disposal fees, and air consumption, thereby potentially cutting the operating cost of a paint line by half. Its precision application reduces the need for masking and containment, decreasing labor time as well as preparation and clean up costs. You'll also spend less on personal protective equipment, booth maintenance, and energy.

What's more, DUX's superior atomization technology enhances finish quality, thereby increasing your competitive advantage – while delivering a better product for your customers.

TECHNOLOGY THAT'S EASY TO USE AND EASY ON US.

Most gravity feed spray guns incorporate bulky, front-heavy body designs that are made even heavier by the addition of heavy fluid cups. With the DUX Gravity Feed's short air passages, the body of the gun is more compact which makes it lighter, more ergonomic, and much easier to use. A center mounted fluid cup also helps balance the gun, leading to reduced arm and wrist fatigue. Finally, lower operating pressures result in massive reductions in unhealthy paint booth fog and overspray, drastically improving the work environment for everyone involved. The way we see it, clearer air isn't just a regulatory mandate. It's the responsible thing to do.

IMMEDIATE ROI

- > Reduced coating usage
- > Decreased cleanup costs
- > Faster production speed
- > Energy savings

EASY TO USE

- > Lightweight and balanced design
- > Outstanding utility across coatings and applications

ENVIRONMENTAL COMPLIANCE

- > Drastic reductions in VOC emissions
- > Reduced HazMat clean-up and disposal
- > AQMD compliant by definition
- > Reduced booth fog and overspray

ADVANCED TECHNOLOGY

- > Laminar airflow
- > Low pressure with high velocity
- > Exceptional atomization

THE DESIGN ISN'T IT'S ONLY STUNNING FEATURE.

See for yourself. Compare the DUX spray gun to any other spray equipment on the market. You'll find that most competing technologies incorporate angular twists and turns within the air passage, along with long travel distance between the air inlet and air cap. As a result, longer distances and more restrictive air passages create friction and severe air turbulence. Bottom line — it's hard to control and shape air at the air cap when it's out of control inside the gun.

With the DUX spray gun, you'll never have that problem. It is designed with smooth sweeping air passages, fewer obstructions, and shorter distance between the inlet and air cap. The result is minimal air pressure loss through the spray gun and extremely organized and controllable airflow.

ORDERING INFORMATION

Selection of the proper fluid tip and air cap for your particular application depends on many factors. Please contact your DUX Distributor or DUX Customer Service for recommended configurations and set-up parameters.

With DUX Aluminum Cup

CUP	AIR CAP	FLUID TIP SIZE								
		0.6mm	0.8mm	1.0mm	1.2mm	1.4mm	1.6mm	1.8mm	2.0mm	2.2mm
600ML ALUMINUM CUP	GENERAL PURPOSE (A1)	G1120-06	G1120-08	G1120-10	G1120-12	G1120-14	G1120-16	G1120-18	G1120-20	G1120-22
	LOW SOLIDS (A0)	G1020-06	G1020-08	G1020-10	G1020-12	G1020-14	G1020-16	G1020-18	G1020-20	G1020-22
	HIGH SOLIDS (A2)	G1220-06	G1220-08	G1220-10	G1220-12	G1220-14	G1220-16	G1220-18	G1220-20	G1220-22

With 3M™ PPS™ Standard Cup

CUP	AIR CAP	FLUID TIP SIZE								
		0.6mm	0.8mm	1.0mm	1.2mm	1.4mm	1.6mm	1.8mm	2.0mm	2.2mm
STANDARD PPS STARTER CUP KIT (25 OZ)	GENERAL PURPOSE (A1)	G1102-06	G1102-08	G1102-10	G1102-12	G1102-14	G1102-16	G1102-18	G1102-20	G1102-22
	LOW SOLIDS (A0)	G1002-06	G1002-08	G1002-10	G1002-12	G1002-14	G1002-16	G1002-18	G1002-20	G1002-22
	HIGH SOLIDS (A2)	G1202-06	G1202-08	G1202-10	G1202-12	G1202-14	G1202-16	G1202-18	G1202-20	G1202-22

* Other Aluminum & PPS cup sizes also available.

DUX GRAVITY FEED SPECIFICATIONS

BODY MATERIAL	Investment Cast Aluminum
FLUID PASSAGE MATERIAL	Stainless Steel
AIR CAP MATERIAL	Anodized Aluminum
WEIGHT (w/o cup)	13.6 oz.
MAXIMUM ATOMIZING AIR PRESSURE*	A0 Air Cap: 10.5 psig A1 Air Cap: 10.7 psig A2 Air Cap: 11.0 psig
AIR INLET	1/4" NPS Male
FLUID CUP FITTING	M12 X 1.5
TRIGGER PRESSURE	39.8 oz.
AIR CONSUMPTION (at 10 psi)	A0 Air Cap: 8.9 scfm A1 Air Cap: 10.2 scfm A2 Air Cap: 11.0 scfm
MAX. USABLE FAN PATTERN (at 9" from target)	14-16"

* Maximum inlet pressure to maintain HVLP compliance (10 psi or less at the air cap)

DUX Gravity Feed Spray Gun

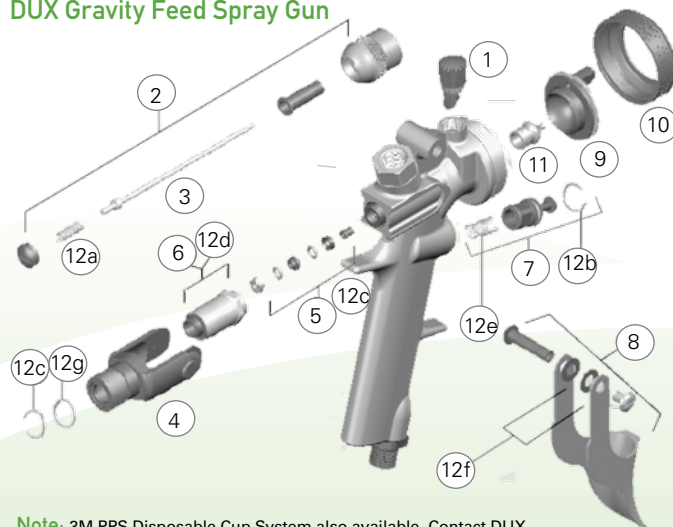

Note: 3M PPS Disposable Cup System also available. Contact DUX Customer Service for more information.

No.	Part	Description
1.	310110	Fan Control Assembly
2.	310116	Fluid Control Assembly
3.	310118	Standard Fluid Needle
4.	310125	Yoke
5.	310128	Fluid Packing Kit
6.	310126	Yoke Spring Assembly
7.	310159	Air Valve Trigger Kit
8.	310131	Trigger Kit
9.	310149	A0 Air Cap Low Solids (Alum)
	310150	A1 Air Cap Genl Purpose (Alum)
	310151	A1 Air Cap Genl Purpose (SS)
	310227	A2 Air Cap High Solids (Alum)
	310233	A0T Air Cap Tester
	310230	A1T Air Cap Tester
	310232	A2T Air Cap Tester
10.	310156	Air Cap Ring
11.	310237	Fluid Tip 0.4mm
	310250	Fluid Tip 0.6mm
	310251	Fluid Tip 0.8mm
	310252	Fluid Tip 1.0mm
	310253	Fluid Tip 1.2mm
	310254	Fluid Tip 1.4mm
	310255	Fluid Tip 1.6mm
	310256	Fluid Tip 1.8mm
	310257	Fluid Tip 2.0mm
	310258	Fluid Tip 2.2mm
No.	Part	Description
12.	310171	Wearable Parts Kit Including:
	12a.	(1) Needle Spring
	12b.	(1) Trigger Air Valve C-Clip
	12c.	(1) Needle Packing Kit
	12d.	(1) Yoke Spring Assembly
	12e.	(1) Trigger Spring
	12f.	(2) Washers
	12g.	(1) Fluid Control O-Ring
	310160	Fluid Control O-ring 5-pack
Accessories		
	310192	1/4" Air Hose
	310260	600ml DUX Aluminum Cup
	310259	1 liter DUX Aluminum Cup
	310174	DUX 10mm Fluid Tip Driver
	310205	Spray Gun Lube (8 oz)
	310206	Spray Gun Lube (2 oz)
	310173	DUX Fluid Packing Tool
	310309	DUX Multi-Tool Wrench
	310175	Exterior Cleaning Brush
	310176	Fluid Tube Cleaning Brush



advanced research environmental atomization

3325 South 116th Street, Suite 161 | Seattle, WA 98168 1974 USA | tel 888 DUX AREA (888 389 2732) fax 866 876 1233 | www.duxarea.com

The design and technology forming the basis of this product is the confidential information of DUX AREA Inc., a Washington corporation. The relevant US Patent Numbers are: US 6,793,157; US 6,425,533, and U.S. 7,004,404. DUX AREA Inc. may have additional patents, patent applications, trademarks, copyrights, or other intellectual property rights covering subject matter in this document. Except as expressly provided in any written license agreement from DUX AREA Inc., this document does not grant you any license to or rights in any such patents, trademarks, copyrights, or other intellectual property.

DUX, DUX Area, DUX Gravity Feed, DUX Pressure Feed, DUX Automatic are either registered trademarks or trademarks of DUX AREA Inc. in the United States and/or other countries.

© 2006 DUX AREA Inc. All rights reserved. Printed in the United States of America

Rev. 3 Part# 510043